

CAUTION
Head must be locked firmly before starting arc.

SEE GUIDE FOR ADDITIONAL
TORCH FRONT END OPTIONS

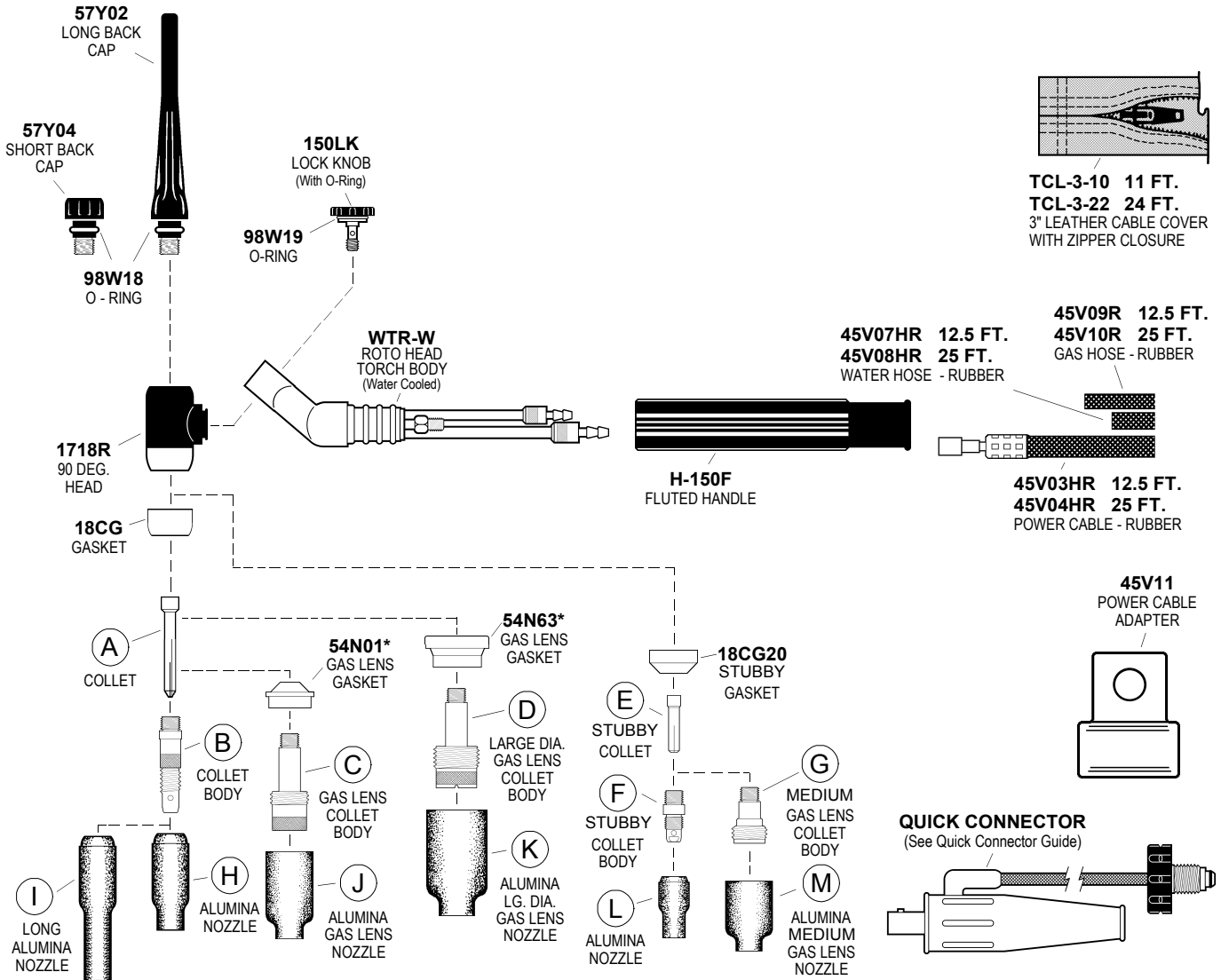

COPYRIGHT 2002 - 2015 TEC WELDING PRODUCTS, INC.

COLLETS • COLLET BODIES • GAS LENS

| ITEM | ELECTRODE DIAMETER | .020 0,5 | .040 1,0 | 1/16 1,6 | 3/32 2,4 | 1/8 3,2 | 5/32 4,0 |
|------|--------------------|-------------|-------------|-------------|-------------|------------|-------------|
| A | COLLET | 10N21 | 10N22 | 10N23 | 10N24 | 10N25 | 54N20 |
| B | COLLET BODY | 10N29 | 10N30 | 10N31 | 10N32 | 10N28 | 406488 |
| C | GAS LENS | 45V29 | 45V24 | 45V25 | 45V26 | 45V27 | 45V28 |
| D | LG. DIA. GAS LENS | — | — | 45V116 | 45V64 | 995795 | 45V63 |
| E | STUBBY COLLET | — | — | 10N23S | 10N24S | 10N25S | — |
| F | STUBBY COLLET BODY | — | — | 17CB20 | | | — |
| G | MEDIUM GAS LENS | — | — | 45V25S | 45V26S | 45V27S | — |

GAS NOZZLES

| ITEM | NO. SIZE | 4 1/4" | 5 5/16" | 6 3/8" | 7 7/16" | 8 1/2" | 10 5/8" | 11 11/16" | 12 3/4" |
|------|---------------------------|-----------|------------|-----------|------------|-----------|------------|--------------|------------|
| H | ALUMINA | 10N50 | 10N49 | 10N48 | 10N47 | 10N46 | 10N45 | — | 10N44 |
| I | ALUMINA 3" LONG | — | 10N49L | 10N48L | 10N47L | — | — | — | — |
| J | ALUMINA GAS LENS | 54N18 | 54N17 | 54N16 | 54N15 | 54N14 | — | 54N19 | — |
| K | ALUMINA LG. DIA. GAS LENS | — | — | 57N75 | — | 57N74 | 53N88 | — | 53N87* |
| L | ALUMINA | 13N08 | 13N09 | 13N10 | 13N11 | 13N12 | 13N13 | — | — |
| M | ALUMINA MEDIUM GAS LENS | — | — | — | 54N15SW | 54N14SW | 54N12SW | 54N19 | — |

* #15 53N89 15/16" ID X 1 7/8" Long

* Must be used together with 18CG gasket.

Specifications and descriptions subject to change without notice.

MANUFACTURED IN USA
TEC WELDING PRODUCTS, INC. • PO BOX 1870 • SAN MARCOS, CA 92079 • (760) 747-3700

www.tectorch.com

e-mail info@tectorch.com

www.weldtec.com

REVISION E